

S
S
S
S
S
S
S
S
S
S
S
S
S

H
H
H
H
H
H
H
H
H
H
H
H
H

E
E
E
E
E
E
E
E
E
E
E
E
E

P
P
P
P
P
P
P
P
P
P
P
P
P

H
H
H
H
H
H
H
H
H
H
H
H
H

E
E
E
E
E
E
E
E
E
E
E
E
E

R
R
R
R
R
R
R
R
R
R
R
R
R

D
D
D
D
D
D
D
D
D
D
D
D
D

S H E P H E R D

89

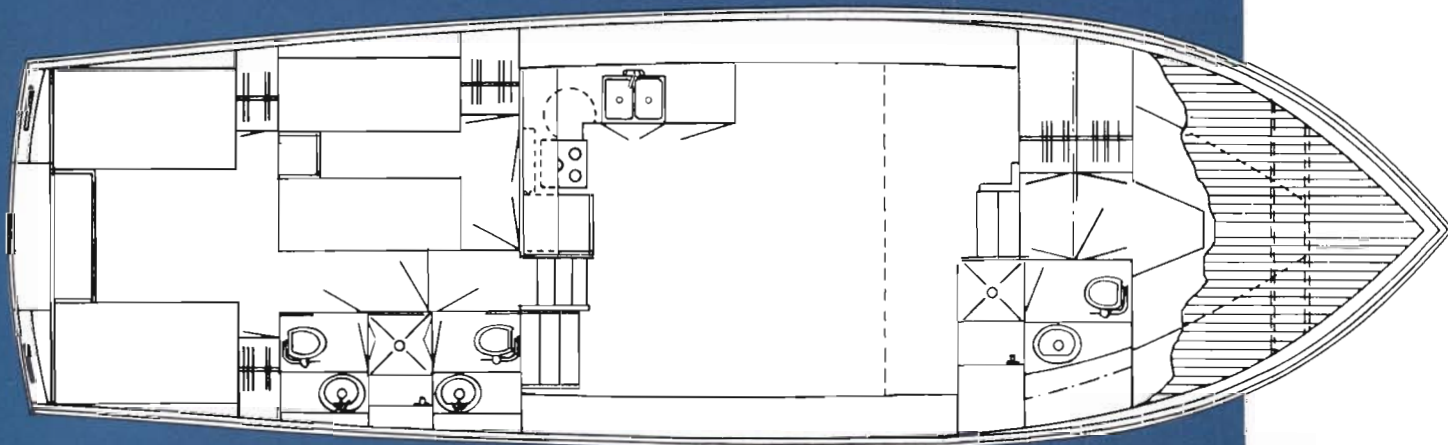
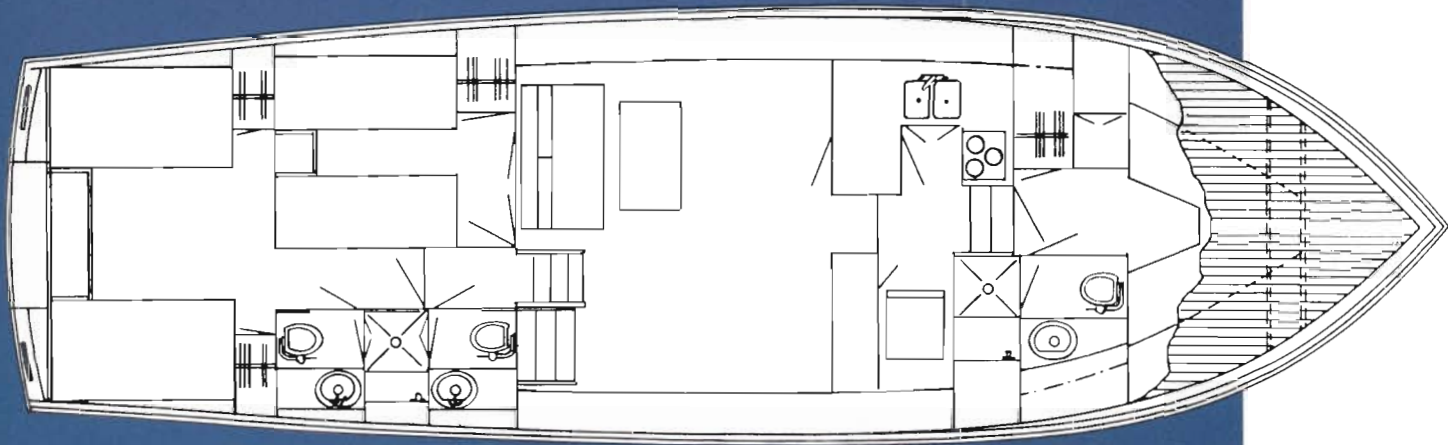

1969
Shepherd
50
MOTOR
YACHT

SPECIFICATIONS

Length	50' 0"
Beam	15' 3 1/2"
Draft	3' 10"
Freeboard—Forward	6' 5"
—Aft	5' 9"
Height from waterline	13' 10"
Height from bottom of cradle	16' 7"
Weight (approx)	46,000 lbs.
Headroom	6' 5"
Fuel Capacity	380 Imperial gals. 457 U. S. gals.
Fresh Water Capacity	170 Imperial gals. 204 U. S. gals.
Bottom	13/16" Philippine Mahogany Plank over 1/4" plywood Total thickness 1 1/8"
Frames	Selected White Oak 1 1/8" x 3 3/4"
Topsides	13/16" Philippine Mahogany Plank over 1/4" plywood
Transom	13/16" Philippine Mahogany Plank over 1/4" plywood
Speeds	to 22 MPH
Steering	Mechanical
Deck	Solid teak plank over laminated layers of marine plywood. Total thickness 1 5/8"

STANDARD EQUIPMENT

Anchor (40 lbs.) with chocks, 100' line and deck pipe • Audible Alarm System for engines (low oil pressure/high water temperature) • Batteries (5) 12V (gas engines) • Beverage Cabinet • Bedspreads in Master and Aft Guest Staterooms • Bilge Pumps (2)—automatic electric • Bilge Pump—heavy duty hand pump—mounted • Blowers (2) • Breadboard • Bonded against electrolysis • Cabinet decor, traditional • Canvas—Weather Curtain—Roll up aft and side curtains with plastic windows and zippers to fully enclose aft deck • Carpeting throughout • Chart drawer under bridge counter • Chocks, cleats, bitts, unicleats • Compass (5") • Dish locker • Dishwasher • Doors (sliding) along main salon side • Draperies and Valances • Drawers used throughout • Engine compartment floor lined with linoleum • Exhaust Fan—galley • Fibreglass covered cabin and hardtop • Flagpole (stern)—Mahogany • Garboard drain • Gate valves on engines and heads • Generator—6.5 K.W. automatic auxiliary wired through automatic breaker panel • Glass—laminated safety plate throughout • Glass racks • Handrails (cabin) • Hardtop—full length to transom with sliding windows, headlining and domelights • Hatch with deadlight • Hatch screen—forward • Heads (3) electric • Helmsman's chair—Deluxe double with cabinet under • Hide-a-bed • Horns—(twin trumpet)—chrome • Hydraulic reverse • International running lights • Instrumentation (complete) • Insulated engine compartment • Lamps (110V) in aft stateroom, main salon, forward stateroom, guest stateroom and each toilet room • Lazy Susan in galley • Lights in all cab-

ins and engine compartment • Light in each hanging locker when door opens • Limber chain • Lines (2) 50' 1/2" nylon dock lines • Louvered galley doors • Mast (lighted) Mahogany with yardarm—hinged • Mirrors (4) • Moulding and trim (stainless steel) • Mufflers • Overhead Instrument Console • Pressure water system—hot & cold (automatic) • Railing from bow to taffrail (stainless steel) • Rattan sections in all doors • Reduction 3-1 gas • Refrigerator—freezer (12 cu. ft.) • Removable section in cabin roof for engine replacement • Seat with cushions—full width across forward cabin with storage under • Screens • Sliding screen for companionway hatch • Shoreplug inlets (2 each side) and 14 110V double outlets wired through automatic breaker panel with Power Sentry (polarity indicator) and 2-50' shore cords • Showers (2) tiled, enclosed—with doors, sump pumps • Staterooms (twin aft) with 2 berths, drawers, hanging locker and bedspreads • Stove-oven-roisserie with hood (110V) • Switch for batteries (Paralleling) • Switches on walls for 110V fixtures • Table—Hi-Lo • Teak decks fore, aft and sides • Teak treatment • Toilet rooms (3) enclosed • Towel Racks (2) • Upholstery, carpet, drapery, interior wood finish, etc. (Owner's choice) • Vanity, 2 large hanging lockers and chest of drawers featured in aft stateroom • Ventilating upper middle windshield with wind-up assembly • Water connection dockside/Starboard • Window in cabin door • Window locks • Windshield Wipers (3) heavy duty • Worm shoe.

IF DIESEL POWERED, STANDARD PRICE INCLUDES:

Batteries—1-200 Amp per main engine and 2-70 Amp for generator • Drip pans under engines • Generator—6 K.W. diesel—automatic with hush cover • Insu-

lated engine compartment • Mufflers • Reduction 2:1.

SAFETY EQUIPMENT (Approved)—1969 50' MOTOR YACHT

In Canada

Anchor (40#) w/chocks and 100' 1/2" manila line • Fire extinguisher (1) 5# • Fog bell • Life ring (30") with 50' polypropylene line • Life jackets (8).

In United States

Fire extinguishers (3) 2 1/2# • Fog bell • Life jackets (8).

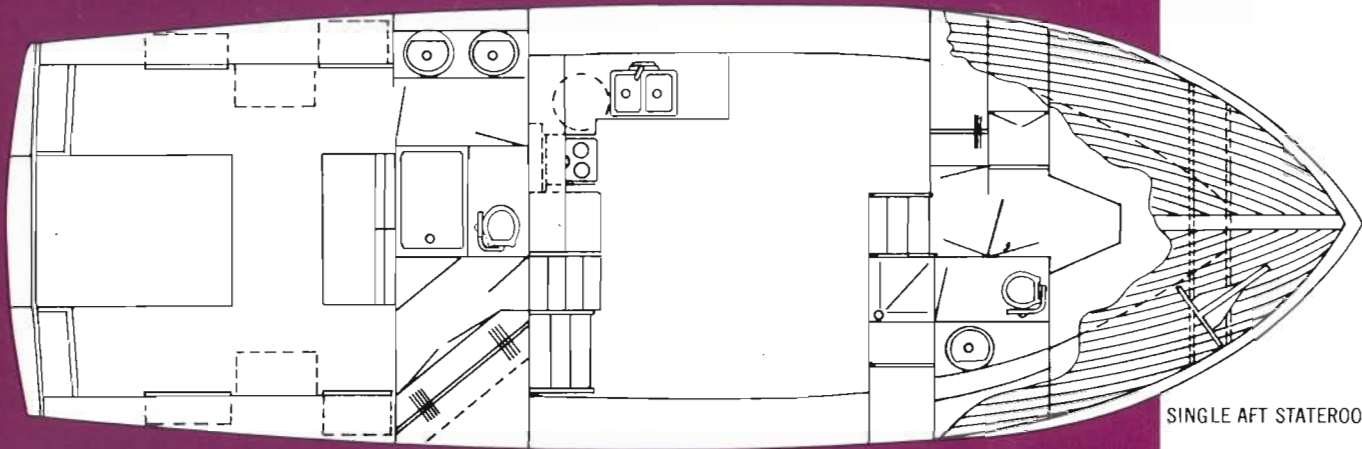

SINGLE AFT STATEROOM

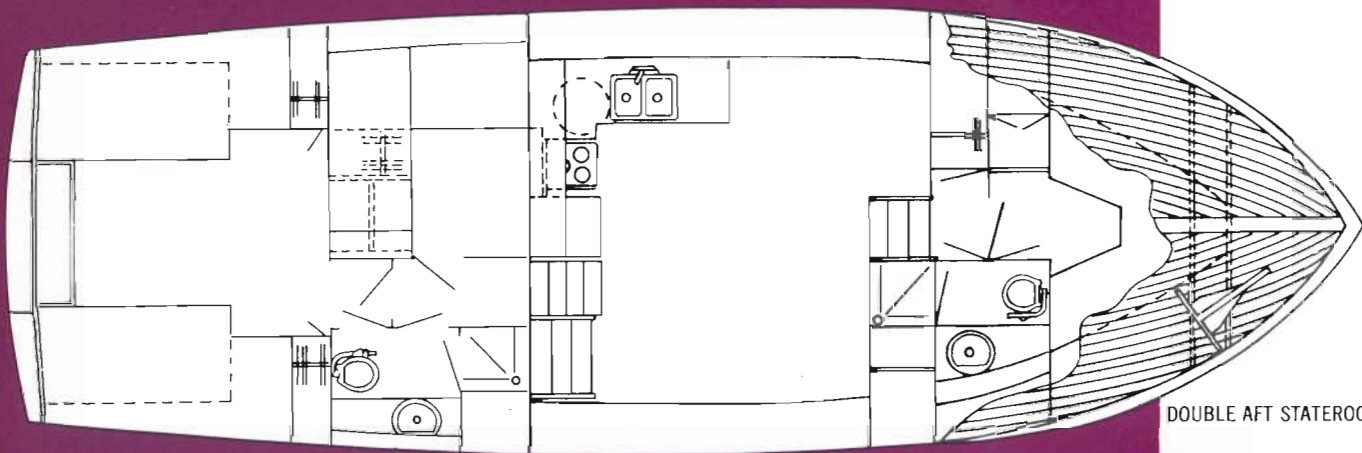

DOUBLE AFT STATEROOM

1969
Shepherd
46
**MOTOR
YACHT**

SPECIFICATIONS

Length	46' 0"
Beam	15' 3 1/2"
Draft	3' 10"
Freeboard—Forward	6' 5"
—Aft	5' 9"
Height from waterline	13' 10"
Height from bottom of cradle	16' 10"
Weight (approx)	30,000 lbs.
Headroom	6' 5"
Fuel Capacity	380 Imperial gals. 457 U. S. gals.
Fresh Water Capacity	170 Imperial gals. 204 U. S. gals.
Bottom	13/16" Philippine Mahogany Plank over 1/4" plywood
Frames	Selected White Oak 1 1/8" x 5"
Topsides	13/16" Philippine Mahogany Plank over 1/4" plywood
Transom	13/16" Philippine Mahogany Plank over 1/4" plywood
Speeds	to 25 MPH
Steering	Mechanical
Deck	Solid teak plank over laminated layers of marine plywood. Total thickness 1 5/8"

STANDARD EQUIPMENT

Anchor (40 lbs.) w/chocks and 100' line • Audible alarm system for engines (low oil pressure/high water temperature) • Batteries (5) 12V (gas engines) • Bedspreads in Master Stateroom • Bilge Pumps (2) automatic electric • Bilge Pump—heavy duty hand pump (mounted) • Blowers (2) • Bonded fully against electrolysis • Breadboard • Cabinet decor, traditional • Canvas—Weather Curtain—Roll up aft and side curtains to fully enclose aft deck with plastic windows and zippers • Carpeting throughout • Chart drawer under bridge counter • Chocks, cleats, bits, unicleats • Compass (5") • Dish Locker • Doors (sliding) along main salon side • Draperies and Valances • Drawers used throughout • Engine compartment floor lined with linoleum • Exhaust fan—galley • Fibreglass covered cabin and hardtop • Flagpole (stern)—Mahogany • Garboard drain • Gate valves on engines and heads • Generator—6.5 K.W. automatic auxiliary wired through automatic breaker panel • Glass—laminated safety plate throughout • Glass racks • Handrails (cabin) • Hardtop—full length to transom with sliding windows, headlining and domelight • Hatch with deadlight • Hatch screen—forward • Heads (2) electric • Helmsman's chair—Deluxe double chair with cabinets under • Hide-a-bed • Horns (twin trumpet)—chrome • Hydraulic reverse • Instrumentation (complete) • Insulated engine compartment • International running lights • Lamps (110V) in aft stateroom, main salon, forward stateroom, and toilet rooms • Lazy Susan in galley • Lights in all cabins and

engine compartment • Light in each hanging locker (goes on when door opens) • Limber chain • Lines (2) 50' 1/2" nylon dock lines • Louvered galley doors • Mast (lighted) Mahogany with yardarm—hinged • Mirrors • Moulding and trim (stainless steel) • Mufflers • Overhead Instrument Console • Pressure water system (hot and cold) automatic • Railing from bow to taffrail (stainless steel) • Rattan sections in all doors • Reduction—3-1 gas • Refrigerator—freezer (12 cu. ft.) • Removable section in cabin roof for engine replacement • Seat—full width with cushions across forward cabin with storage under • Screens • Sliding screen for companionway hatch • Shoreplug inlets (2 each side) and 14 110V double outlets wired through automatic breaker panel with Power Sentry (polarity indicator) and 2-50' shore cords • Showers tiled, (2) enclosed—with doors and sump pumps • Stove-oven-roisserie (110V) • Switch for batteries—paralleling • Switches on walls for 110V fixtures • Table—Hi-Lo • Teak decks fore, aft and sides • Teak treatment • Toilet rooms (2)—enclosed • Towel Racks (2) • Tub in master toilet room with twin basins • Upholstery, carpets, drapery, interior wood finish, etc. (Owner's choice) • Ventilating upper middle windshield with wind-up window assembly • Water connection—dockside, starboard • Windshield Wipers (3) heavy duty • Window locks • Window in Cabin Door • Worm shoe.

IF DIESEL POWERED, STANDARD PRICE INCLUDES:

Batteries—1-200 Amp per main engine, 2-70 Amp for Generator • Drip pans under engines • Generator—6 K.W. diesel • Hush cover for generator • Insu-

lated engine compartment • Mufflers • Reduction 2:1.

SAFETY EQUIPMENT (Approved)—1969 46' MOTOR YACHT

In Canada

Anchor (40#) w/chocks and 100' 1/2" manila line • Fire extinguisher (1) 5# • Fog bell • Life ring (30") with 50' polypropylene line • Life jackets (8).

In United States

Fire extinguishers (3) 2 1/2# • Fog bell • Life jackets (8).

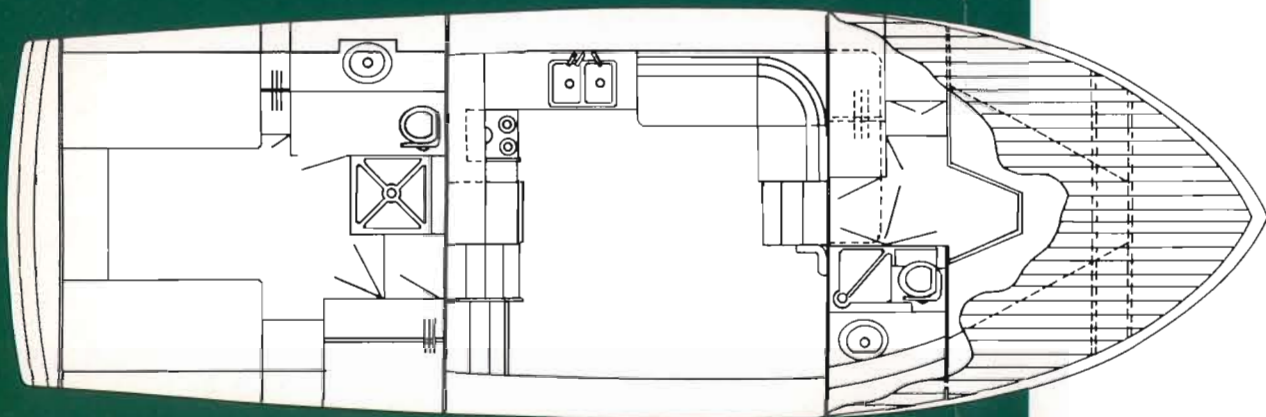

1969
Shepherd
42
MOTOR YACHT

SPECIFICATION

- Length
- Beam
- Draft
- Freeboard—Forward
- Aft
- Height from waterline
- Height from bottom of cradle
- Weight (approx)
- Headroom
- Fuel Capacity
- Fresh Water Capacity
- Bottom
- Frames
- Topsides
- Transom
- Speeds
- Steering
- Deck

STANDARD EQ

Anchor (40 lbs.) w/chocks and 1 high water temp.) for engines • (2)—automatic • Blowers (2) • Cabinet Decor (traditional) • Cabinet out • Chart drawer under bridge pass—5" • Dish locker • Doors and Valances • Drawers used to cover cabin and hardtop • Flap Gate valves on engines and head wired with automatic breaker panel • Glass racks (3) • Handrails (3) forward cabin • Hardtop with slatted Hatch with deadlight • Hatch seat • single seat • Hydraulic reverse compartment • International rule main salon and forward stateroom compartments • Limber Chain • Liner vert to sleeping accommodation

IF DIESEL POWERED, S

Batteries—1-200 Amp for each generator—6 K.W. diesel generator

SAFETY EQUIPMENT (A

In Canada

Anchor (40#) w/chocks and 10' Fog bell • Life ring (30") with 5'

1969

42
MOTOR YACHT

SPECIFICATIONS

Length	42' 0"
Beam	13' 11"
Draft	40"
Freeboard—Forward	71"
—Aft	60"
Height from waterline	12' 6"
Height from bottom of cradle	15' 0"
Weight (approx)	21,000 lbs.
Headroom	6' 5"
Fuel Capacity	265 Imperial gals. 318 U. S. gals.
Fresh Water Capacity	128 Imperial gals. 153 U. S. gals.
Bottom	13/16" Philippine Mahogany Plank over 1/4" plywood
Frames	Selected White Oak 1 1/8" x 4 1/2"
Topsides	13/16" Philippine Mahogany Plank over 1/4" plywood
Transom	13/16" Philippine Mahogany Plank over 1/4" plywood
Speeds	to 28 MPH
Steering	Mechanical
Deck	Solid teak plank over laminated layers of marine plywood. Total thickness 1 5/8"

STANDARD EQUIPMENT

Anchor (40 lbs.) w/chocks and 100' line • Audible Alarm System (low oil pressure/high water temp.) for engines • Batteries (5)—12V (gas engines) • Bilge Pumps (2)—automatic • Blowers (2) • Bonded fully against electrolysis • Breadboard • Cabinet Decor (traditional) • Canvas Weather Curtain, etc. • Carpeting throughout • Chart drawer under bridge counter • Chocks, cleats, bitts, unicleats • Compass—5" • Dish locker • Doors (sliding) along port side main salon • Draperies and Valances • Drawers used throughout • Exhaust fan—galley • Fibreglass-covered cabin and hardtop • Flagpole (stern)—mahogany • Garboard drain • Gate valves on engines and heads • Generator—Auxiliary 6.5 K.W. automatic, wired with automatic breaker panel • Glass (laminated safety plate throughout) • Glass racks (3) • Handrails (cabin) • Hanging locker and chest of drawers in forward cabin • Hardtop with sliding side windows, headlining and domelight • Hatch with deadlight • Hatch screen (forward) • Helmsman's chair—Deluxe—single seat • Hydraulic reverse • Instrumentation (complete) • Insulated engine compartment • International running lights • Lamps (110V) in aft stateroom, main salon and forward stateroom • Lights (12V) in all cabin and engine compartments • Limber Chain • Lines (2) 50' 1/2" nylon • Lounge (L-shaped) to convert to sleeping accommodation • Louvered galley doors • Mast (lighted) Ma-

hogany with yardarm—hinged • Mirrors (4) • Moulding and trim (stainless steel) • Mufflers • Pressure water system—hot & cold (automatic) • Railing (stainless steel) from bow to taffrail • Reduction drive 2.5-1 • Refrigerator—9 cu. ft. • Removable section in cabin roof for possible engine replacement • Seat and cushions across forward cabin window with storage under • Screens • Sliding screen for companionway hatch • Shore plug inlet each side and 12 110V double outlets wired through automatic breaker panel with Power Sentry (polarity indicator) and 1-50' shore cord • Shower, tiled (enclosed) with sump pump and door—also shower forward with curtain and concealed basin • Stove—oven—roisserie (110V) • Switch for batteries—paralleling • Switches on walls for 110V fixtures • Table—Hi-Lo • Teak decks—fore, aft and sides • Teak treatment • Toilet rooms (2) enclosed • Towel racks (2) • Trumpet horns (twin) chrome • Upholstery, carpets, drapery, interior wood finish, etc. (Owner's choice) • Vanity in aft stateroom with drawers, large hanging locker, bedspreads on aft berths • Ventilating upper middle windshield with wind-up center windshield assembly • Water connection, Dockside—Starboard • Window in cabin door • Window locks • Windshield Wipers (3) heavy duty • Worm shoe.

IF DIESEL POWERED, STANDARD PRICE INCLUDES:

Batteries—1-200 Amp for each main engine, 2-70 Amp for Generator • Generator—6 K.W. diesel generator w/hush cover • Drip pans under engines (3)

• Insulated engine compartment • Mufflers • Reduction drive 2:1.

SAFETY EQUIPMENT (Approved)—1969 42' MOTOR YACHT

In Canada

Anchor (40#) w/chocks and 100' 1/2" manila line • Fire extinguisher (1) 5# • Fog bell • Life ring (30") with 50' polypropylene line • Life jackets (8)

In United States

Fire extinguishers (3) 2 1/2# • Fog bell • Life jackets (8).

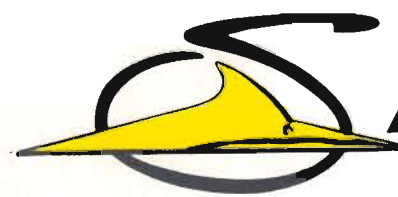
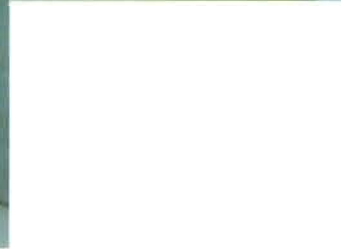

Shepherd BOATS LTD.

NIAGARA-ON-THE-LAKE • ONTARIO, CANADA

A Subsidiary of the Trojan Boat Company

